

New Midland Station Temporary Bus Interchange



To allow for construction of the permanent bus interchange as part of the New Midland Station Project, the existing bus interchange will close. A temporary bus interchange will open on Sunday, 11 May.

The temporary bus interchange will be located in front of the current Midland Station on the site of the former car park.

Services will continue without interruption, but some timetables will be slightly adjusted to allow for additional walking time; however, these changes are not expected to take effect on the first day.

Passenger amenities



Pedestrian routes to bus stands will be clearly signposted



CCTV



Covered bus shelters at each stand



Security staff



Lighting



TAXI

Vehicle (including taxis) pick-up and drop-off is available inside the new multi-storey car park on Victoria Street.

Pedestrian routes during construction of permanent bus interchange

With the closure of the existing bus interchange and the opening of the temporary one, pedestrian and cycling routes will change.

Please follow the designated paths shown on the map overleaf and avoid construction areas for your safety.

We recommend planning ahead and allowing extra travel time during these works.

Temporary bus interchange layout

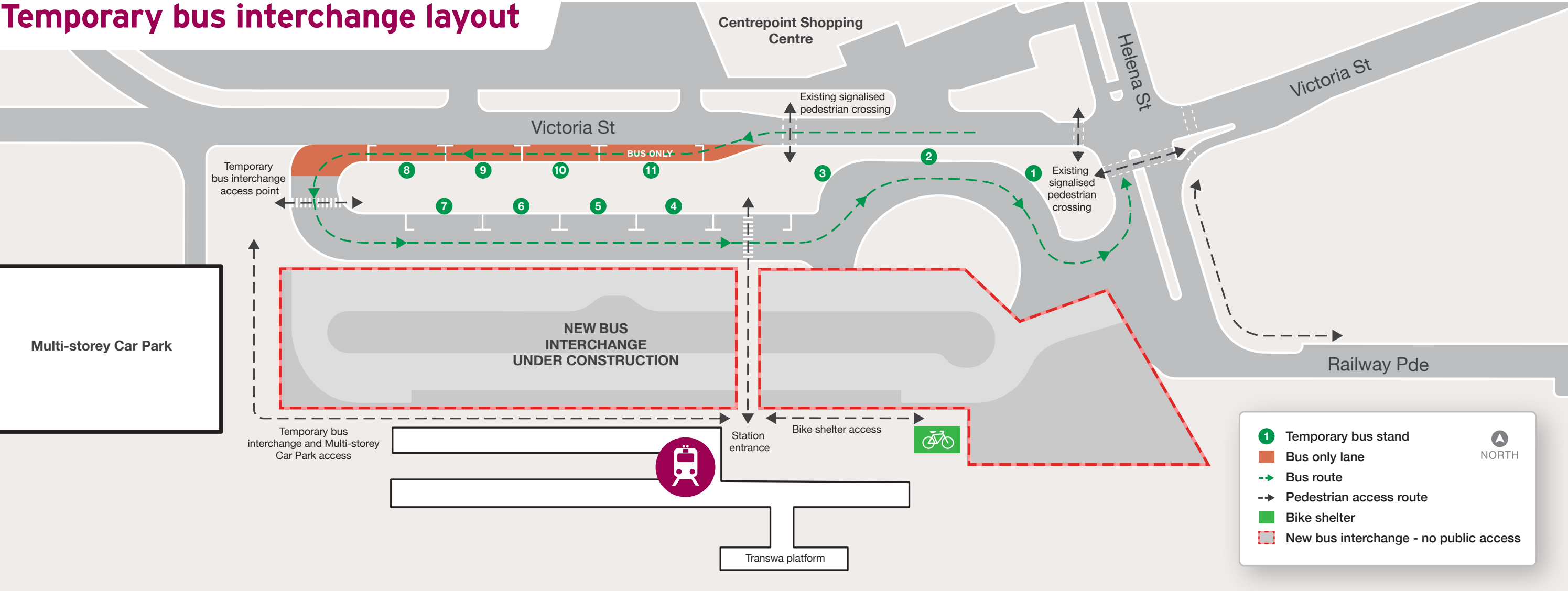

Bus stand information

BUS STANDS	ROUTE
Temporary Stand 1 (Currently Stand 8)	308 to Midland Station (Circular via Viveash) 310 to Ellenbrook Station 312 to Midland Station (Circular via Baskerville) 358 to Whiteman Park Station 359 to Whiteman Park Station
Temporary Stand 2 (Currently Stand 7)	320 to Mundaring Town Centre 328 to Wundowie Town Centre
Temporary Stand 3	307 to Kalamunda Bus Station 321 to Glen Forrest 322 to Glen Forrest
Temporary Stand 4	314 to Midland Station (Circular via Stratton) 315 to Midland Station (Circular via Stratton)

BUS STANDS	ROUTE
Temporary Stand 5	313 to Jane Brook 323 to Swan View 324 to Midland Station (Circular via Stratton) 325 to Midland Station (Circular via Stratton) 326 to Midland Station (Circular via Midvale) 327 to Swan View
Temporary Stand 6	277 to High Wycombe Station 278 to High Wycombe Station
Temporary Stand 7	300 to Midland Station (Circular via Midland Gate)
Temporary Stand 8	290 to Redcliffe Station 291 to Redcliffe Station
Temporary Stand 9	301 to Midland Station (Circular via Midland Hospital) School Specials
Temporary Stand 10	Transwa Road Coach Services
Temporary Stand 11	901 to Perth City (Train Replacement) Set down

Frequently Asked Questions



Will the temporary bus interchange have public toilets?

No. Toilets are available inside Midland Station.

Where can I find the latest information on my bus route and timetable?

For the latest information and updates please visit www.transperth.wa.gov.au.

What will happen to the trees in the existing bus interchange?

Three out of the seven trees in the roundabout at the Midland Station bus interchange will be removed.

Why do the trees have to be removed?

The trees need to be removed to enable the new permanent bus interchange to be built as per the approved design.

Where will the permanent bus Interchange be located?

It will be located between the new Midland Station and the multi-storey car park.

When will the permanent bus interchange open?

The permanent bus interchange is scheduled to open in early-2026. More information will be available prior to opening.

